

Belegungsplan für Weing UC 6 Rahmen IV Galgenfenster

ohne Wetterstehen



Spindel 7
Getriebe-
spindel
L=125mm HUB max. 80
72 Verkrzeuge
oder
(L=150mm HUB max. 90
73 Verkrzeuge)
d=40mm

Spindel 6
L=40mm
d=40mm
unverschraubt

Spindel 4

Spindel 3
L=120mm
d=50mm

Ablängsäge
HM-Säge

Spindel 2
differential-
verschraubt

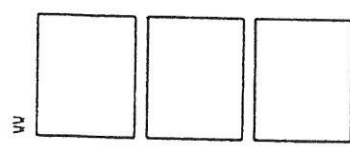
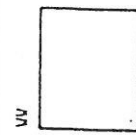
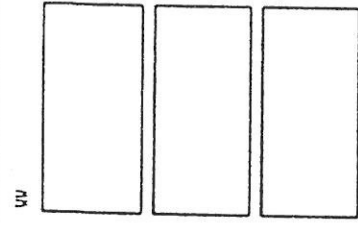
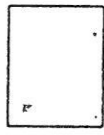
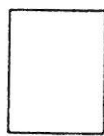
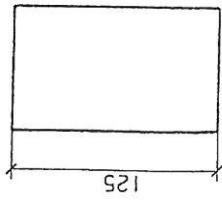
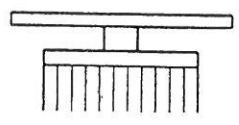
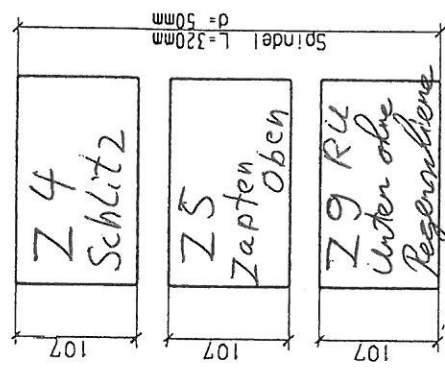
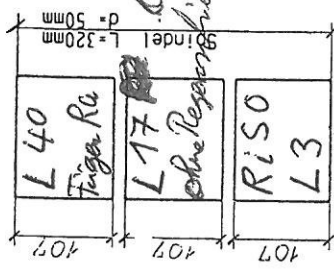

Flügel + Blendrahmen ---> Außenauflege

Belegungsplan für Weinig UC 6 Umfassen 68/78/88 Galgenanker

Rahmen - ohne Wetterständer
Wasserhut ohne Fall

Spindel 7
Getriebe-
spindel
L=125mm HUB max. 80
1/2 Werkzeuge
oder
(L=150mm HUB max. 90
d=40mm
1/3 Werkzeuge)

Spindel 6
L=40mm
d=40KN
Unverschraubt

Spindel 4

Spindel 3
L=120mm
d=50mm

Spindel 2
differential-
verschraubt

Ablasssäge
HM-Säge

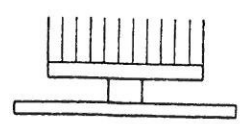
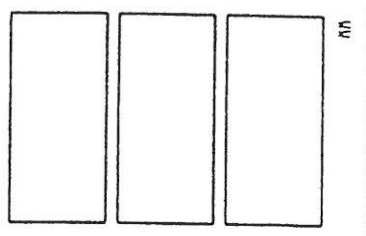
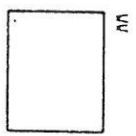
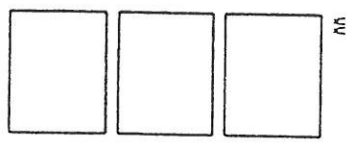
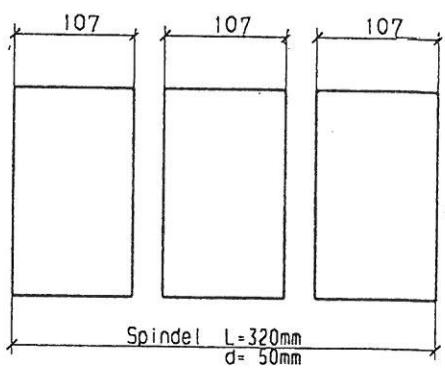
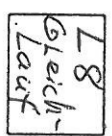
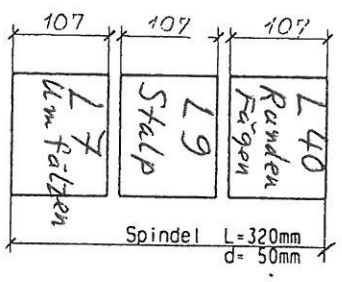
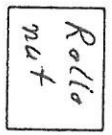
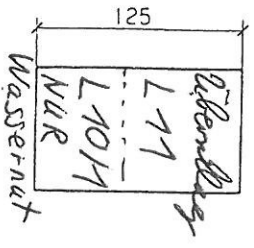

Belegungsplan für Weinig UC 6 HA Rahmen 665/765

- HA Flügel



Spindel 7
Getriebe-
spindel
L=125mm HUB max. 80
72 Werkzeuge
oder
(L=150mm HUB max. 90
73 Werkzeuge)
d=40mm

Spindel 6
L=40mm
d=40KN
unverschraubt

Spindel 4

Spindel 3
L=120mm
d=50mm

Ablängsäge
HM-Säge

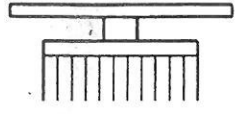

Spindel 2
differential-
verschraubt

Ringe
L42

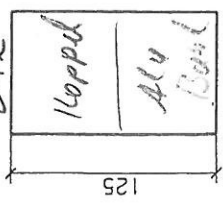

holl

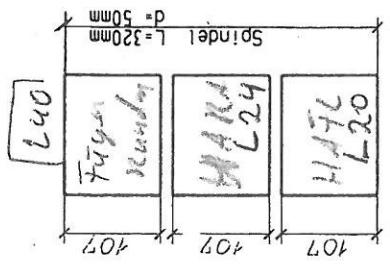

Gleid
L8

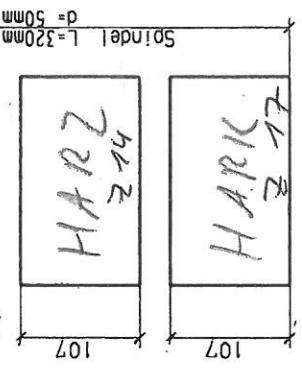

Flügel HA

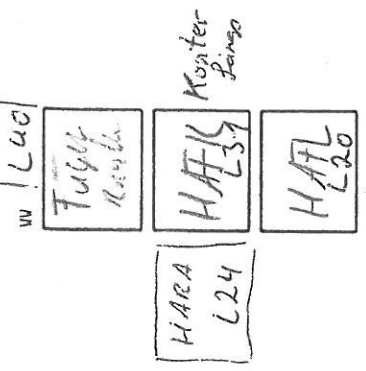
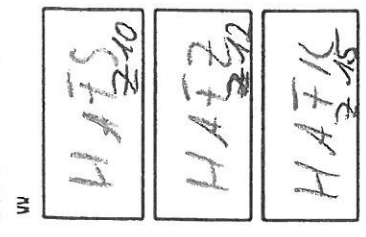

Flügel + Blendrahmen --> Außenaufgabe

Belegungsplan für Weinig UC 6 Umfalten 68/179 88/HA.



Spindel 7
weilrabe-
Spindel
L=125mm HUB max. 80
7/2 Werkzeuge
oder L=150mm HUB max. 90
7/3 Werkzeuge
d=40mm

Spindel 6
L=40mm
d=40KN
unverschraubt

Spindel 4

Spindel 3
L=120mm
d=50mm

Spindel 2
differentiel-
verschraubt

Ablängsäge
HM-Säge

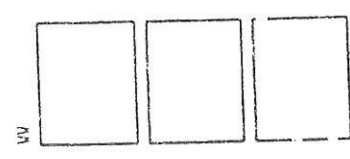
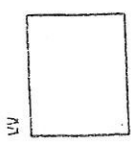
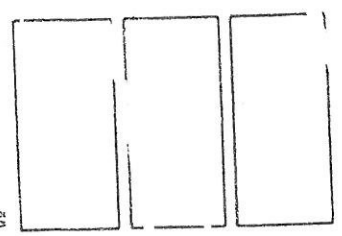
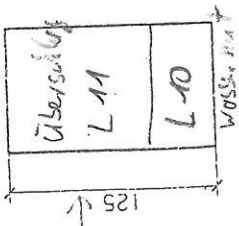
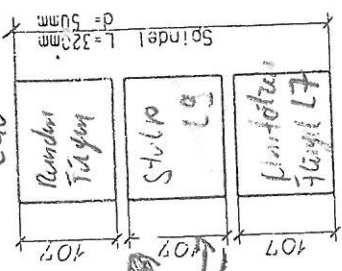
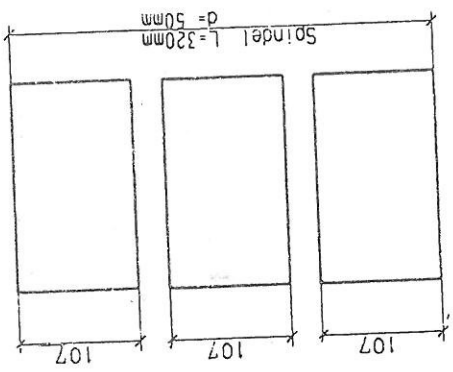
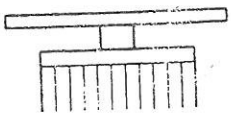

Rollo
nur

Gleich
lauf

Bei Holz
Rau
Schrauben
Bei Alu
Unter 4mm Nutweine
Einbauein

Unter
Stärke

Unter
Stärke

Flügel + Blindrahmen --> Außenauflege

Belegungsplan für Weinig UC 6 Rahmen



Ablängsäge
HM-Säge

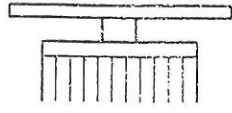

Spindel 7
Getriebe-
spindel
L=125mm HUB max. 80
72 Werkzeuge
oder
(L=150mm HUB max. 90
73 Werkzeuge)
d=40mm

Spindel 6
L=40mm
d=40KN
unverschraubt

Spindel 4

Spindel 3
L=120mm
d=50mm

Spindel 2
differential-
verschraubt

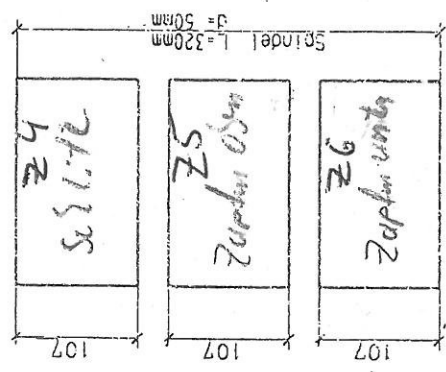
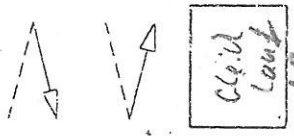
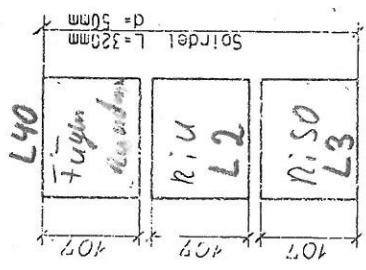
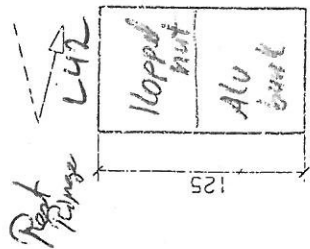

Setzholz / Ringel

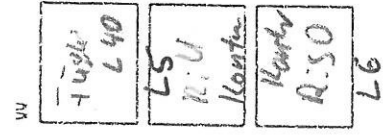
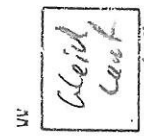
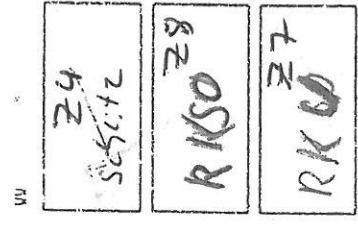

Rahmen Kontur
Linie, Außen

Rahmen Kontur Unt

Belegungsplan für Weinig UC 6 Flügel IV 69/79/88

OPPOLD
SYSTEM
INTERNATIONAL

Spindel 7
Getriebe-
spindel
L=125mm HUB max. 80
/2 Werkzeuge
oder:
(L=150mm HUB max. 90
/3 Werkzeuge)
d=40mm

Spindel 6
L=40mm
d=40KN
unverschraubt

Spindel 4

Spindel 3
L=120mm
d=50mm

Spindel 2
differential-
verschraubt

Ablängsäge
HM-Säge

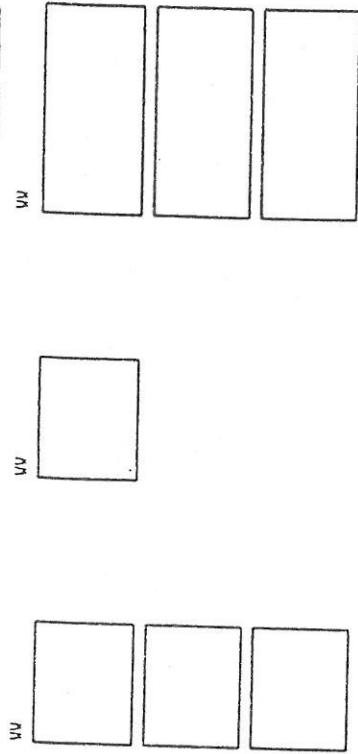
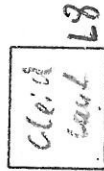
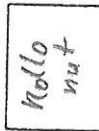
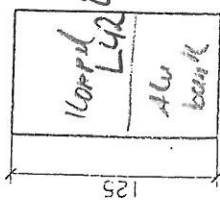
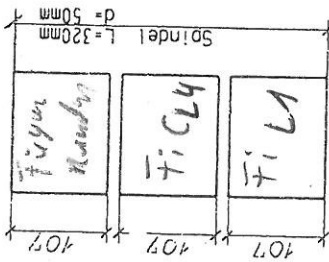
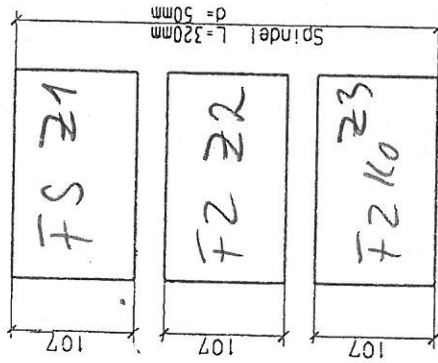
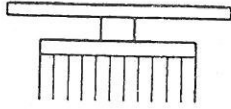

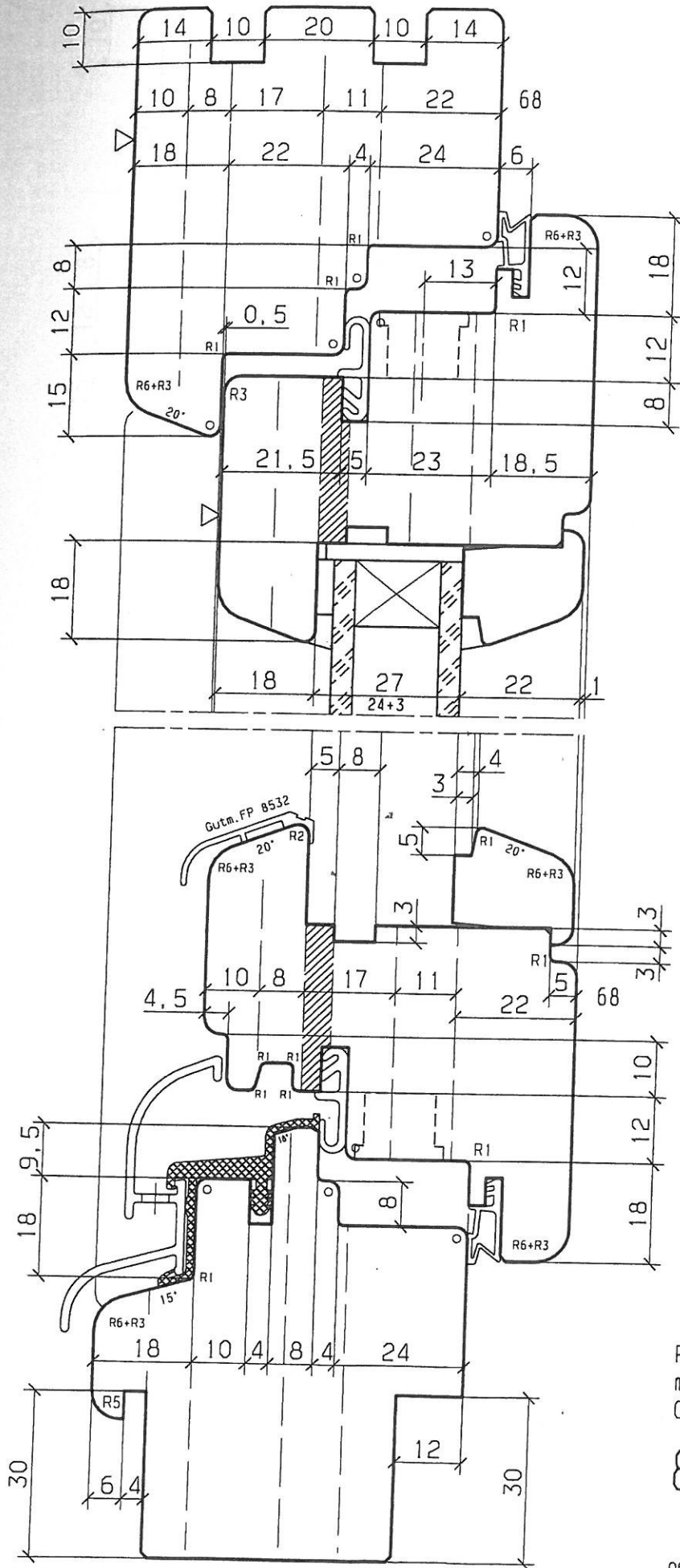

IV 22
E 8/24
H 68/68
FD5 (DEV SV103b)
BKou
B
TrGv

0,5 mm Luft am
Außenanschlag

o = R2

Regenschutzschiene
mit Stockabdeckung
Gutmann Donau 22/24 F-TI

8999-05F 1

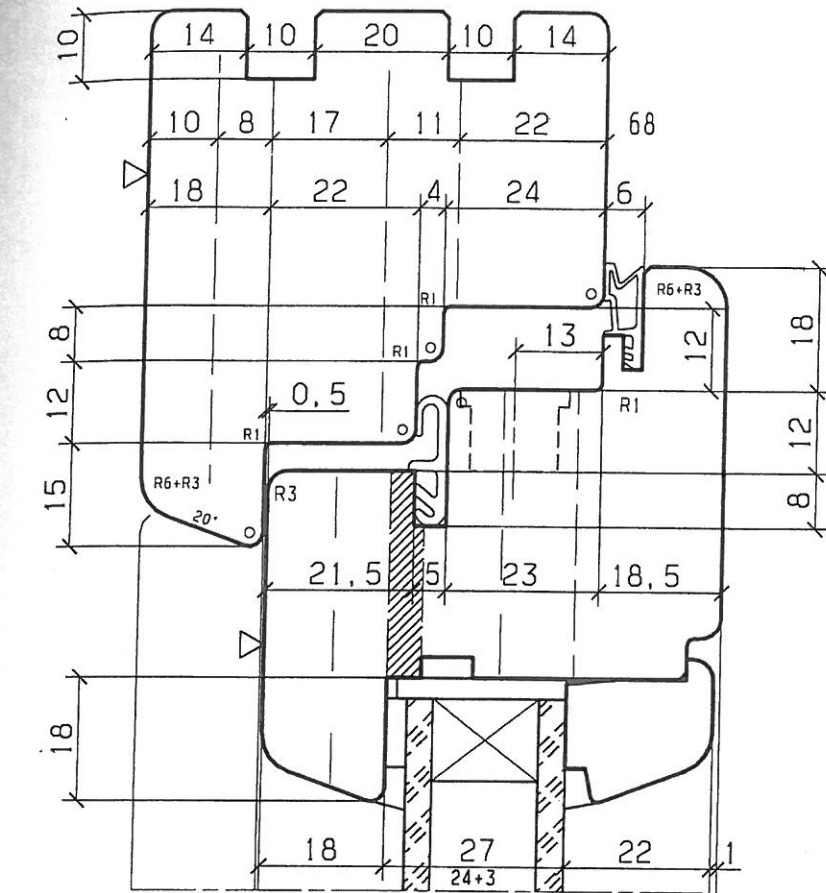

IV 22
E 8/24
H 68/68
FD5 (DEV SV103b)
BKou
B
TrGv

0.5 mm Luft am
Außenanschlag

o = R2

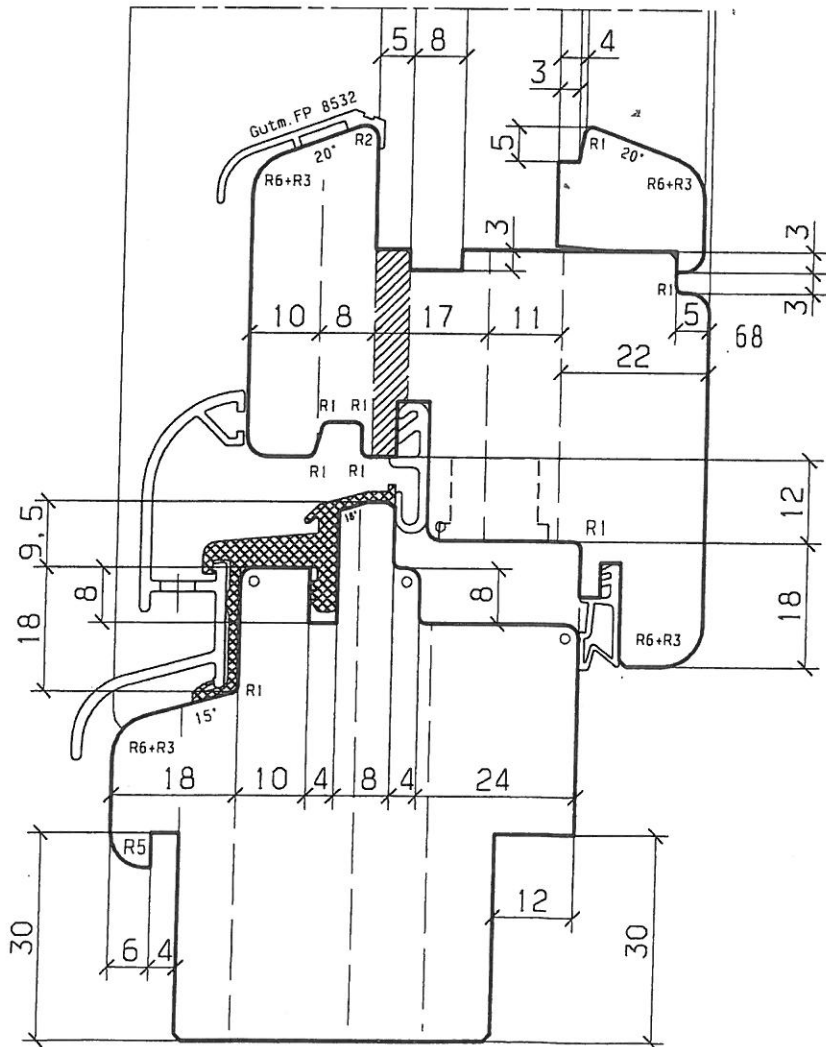

Regenschutzschiene
mit Stockabdeckung
Gutmann Main 22/24 F-TI

8999-05F1/1

gez. : 28.07.05 Ur

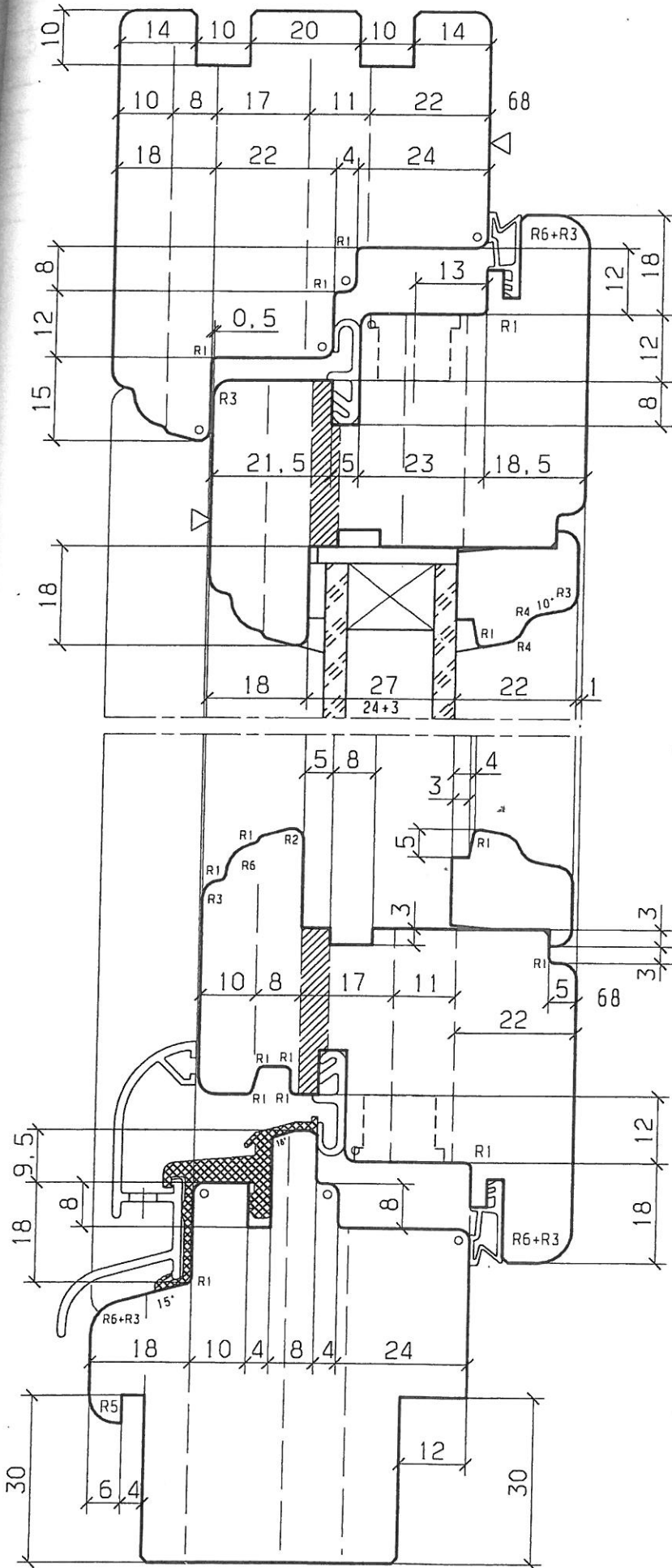

IV 22
E 8/24
H 68/68
FD5 (DEV SV103b)
BKou
B
TrGv

0,5 mm Luft am
Außenanschlag

o = R2

Regenschutzschiene
mit Stockabdeckung
Gutmann Main 22/24 F-TI

8999-05F 1/3

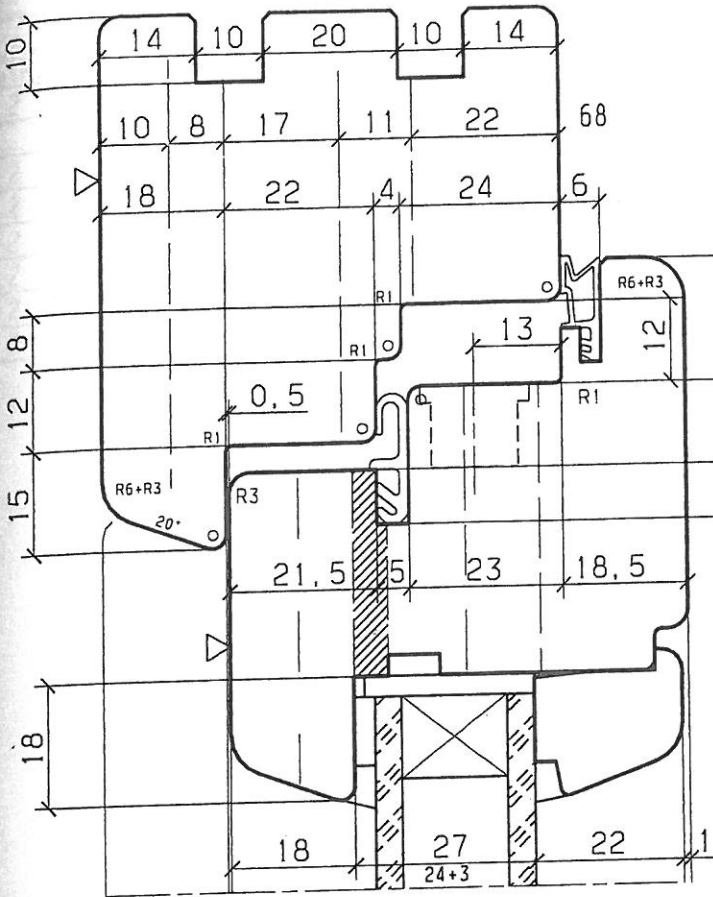

IV 22

o.Schiene

E 8/24

H 68/68

FD5 (DEV SV103b)

BKou

B

TrGv

0,5 mm Luft am
Außenanschlag

o = R2

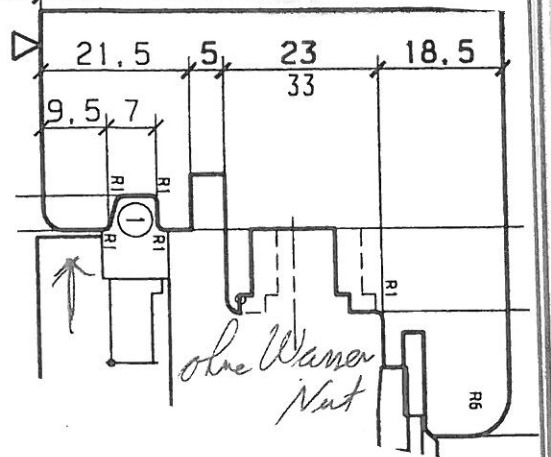
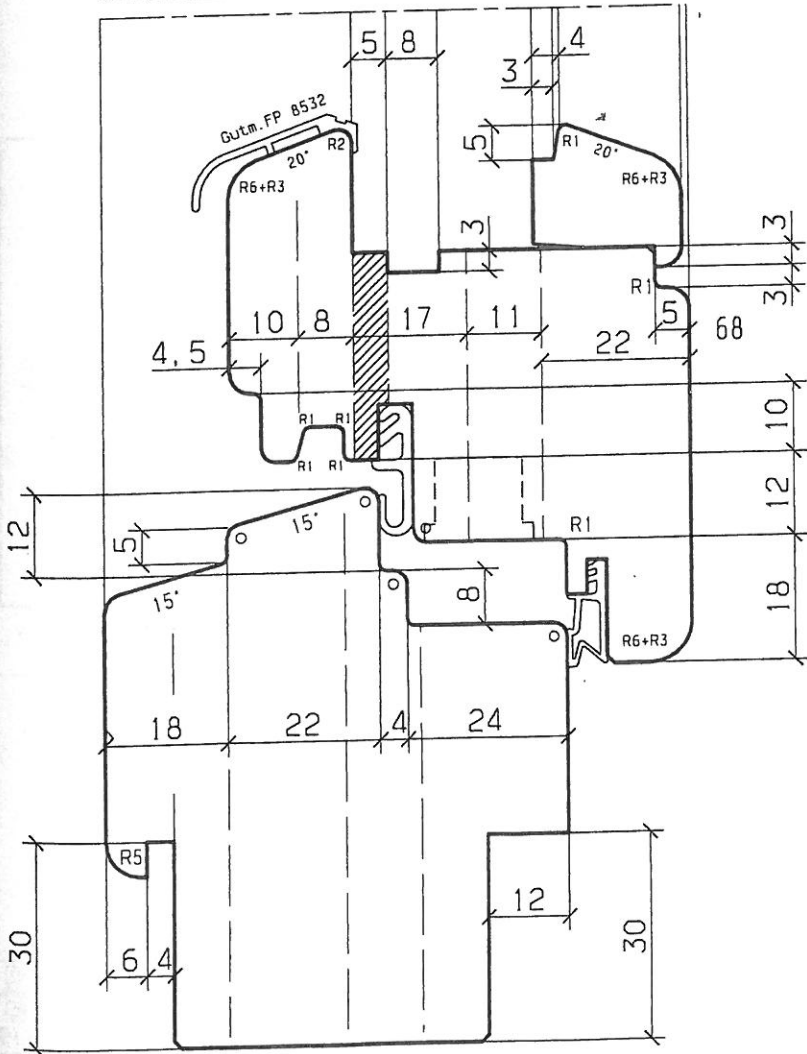

ohne Warner Nut

8999-05F20

gez. : 24.06.05 Ur

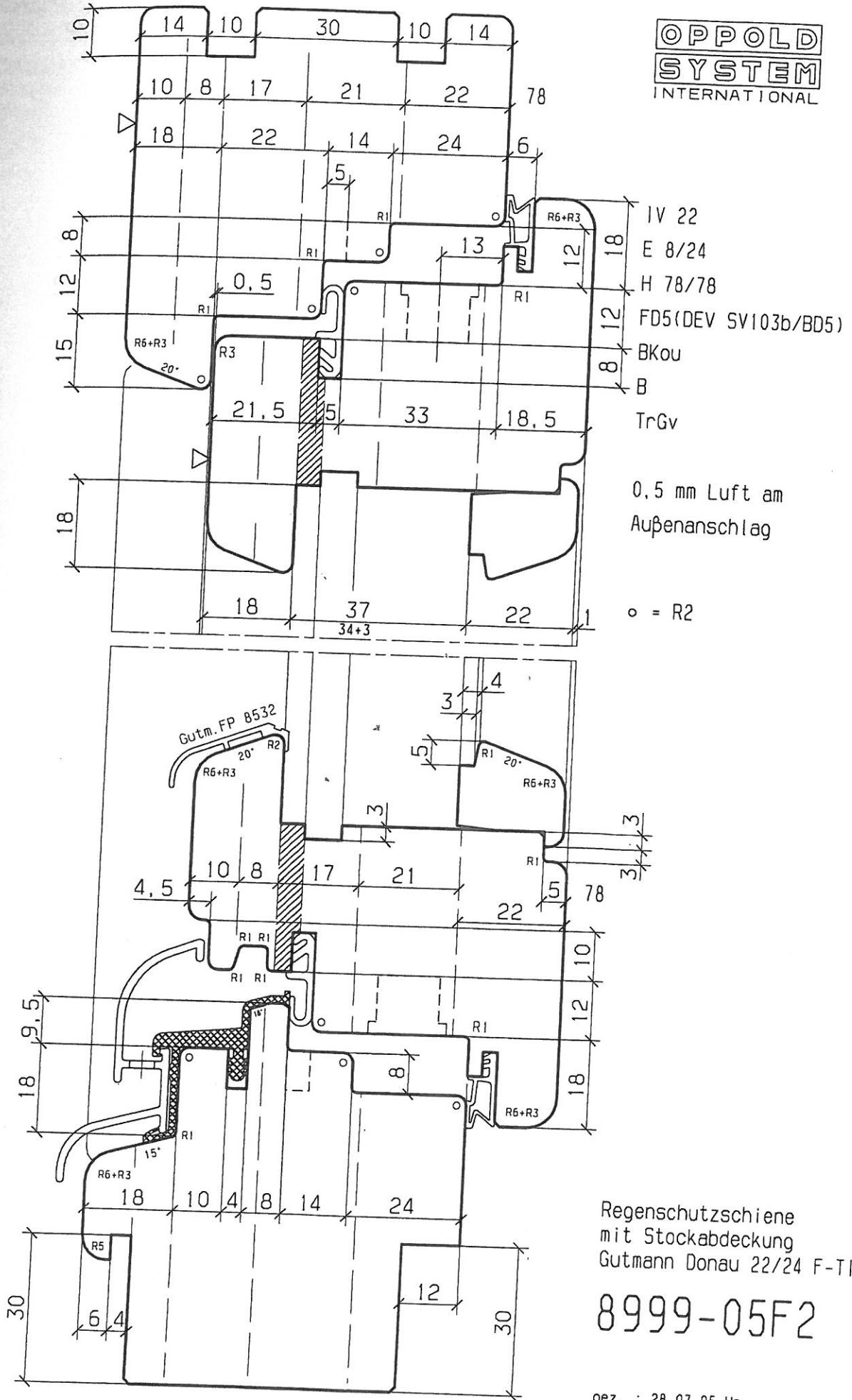

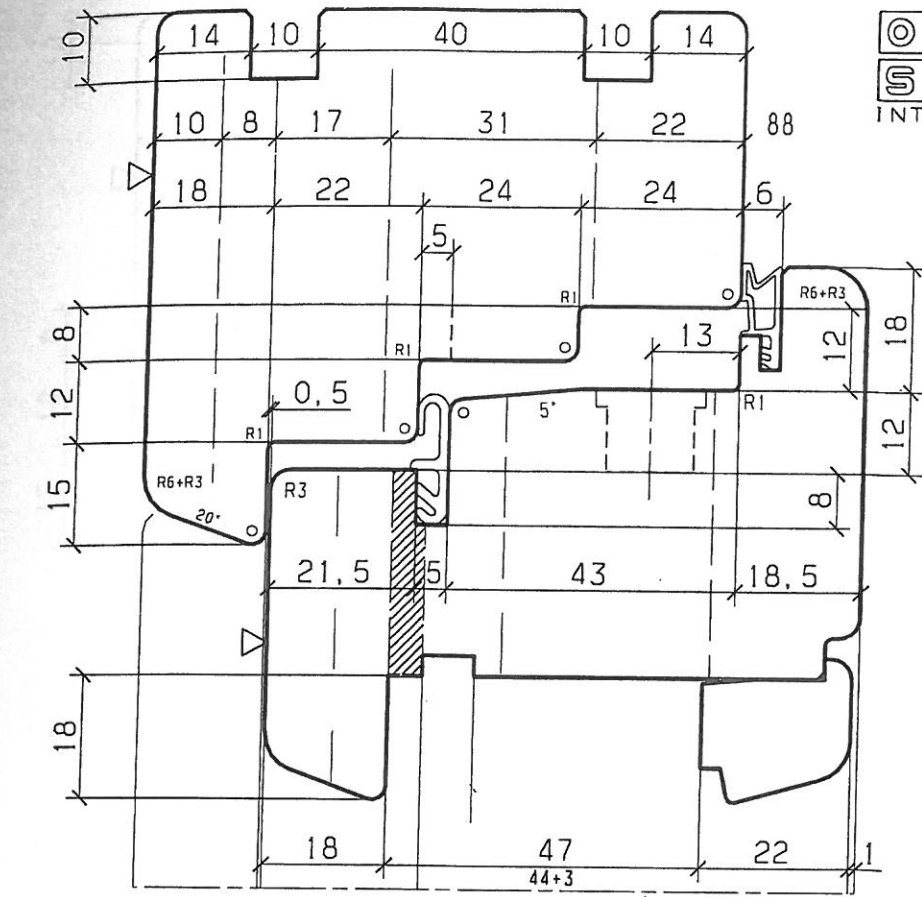

IV 22
E 8/24
H 88/88
FD5 (DEV SV103b/BD5)
BKou
B
TrGv

0,5 mm Luft am
Außenanschlag

o = R2

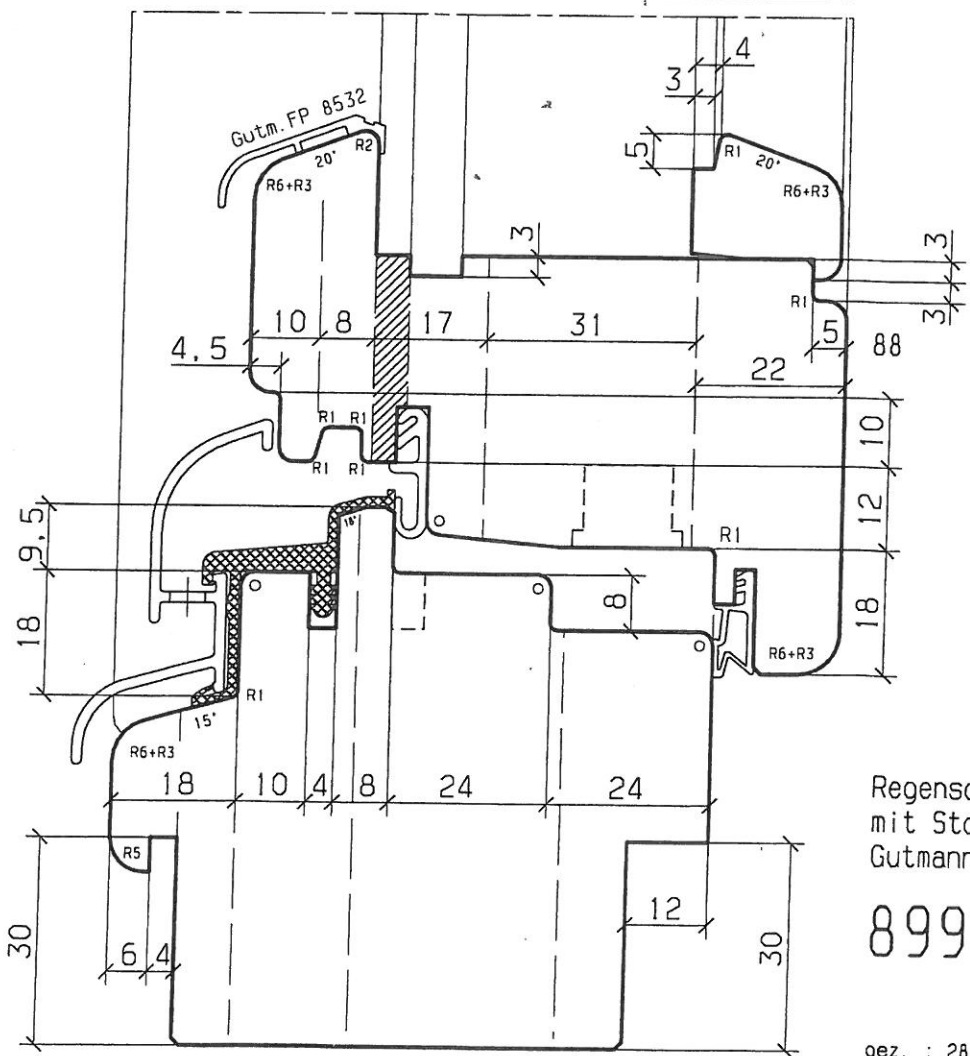

Regenschutzschiene
mit Stockabdeckung
Gutmann Donau 22/24 F-TI

8999-05F3

gez. : 28.07.05 Ur

Mittelfalzschnitt
 für zweiflügelige Fenster
 ohne Setzholz

IV 22

H68

FD5

o = R2
 alle nicht bemaßten
 Radien R3

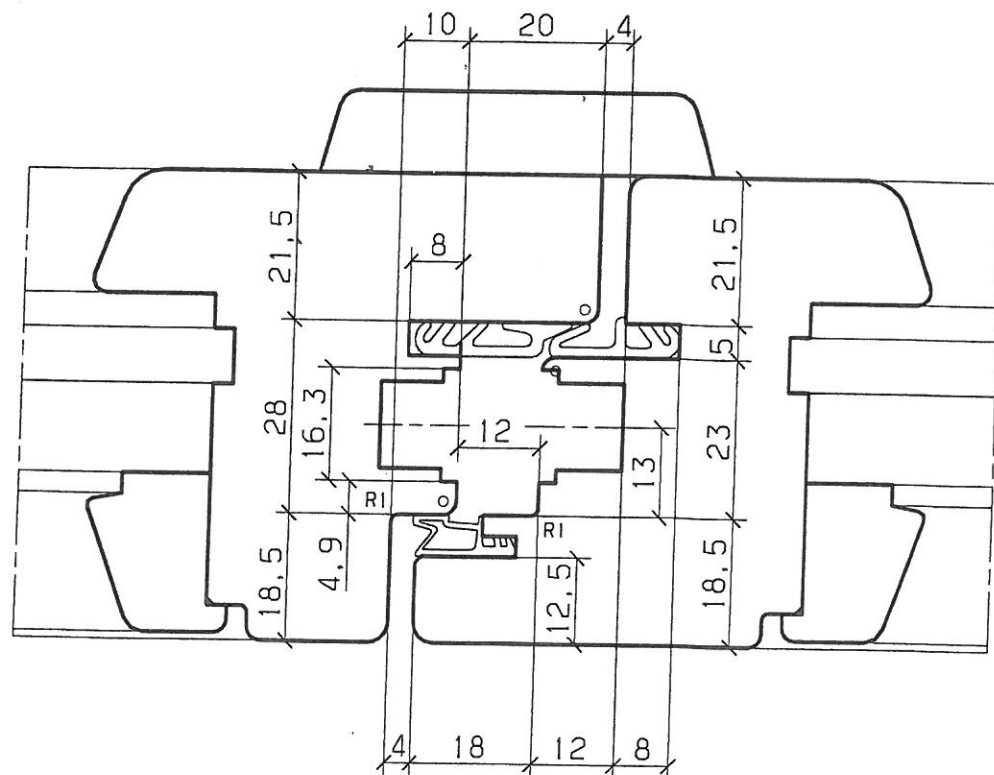

8999-05F4

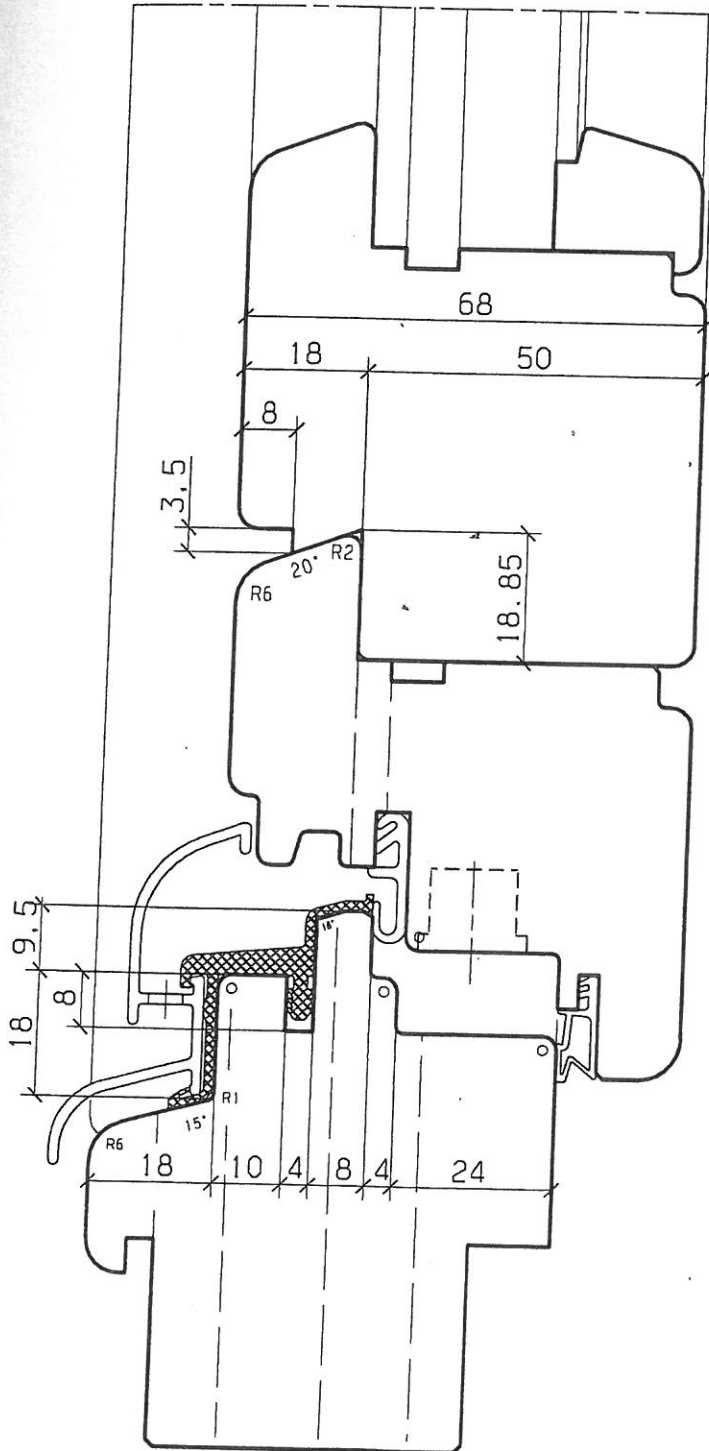

IV 22
E 8/24
H 68/68
FD5(DEV SV103b)

0,5 mm Luft am
Außenanschlag

o = R2

FIC

Regenschutzschiene
mit Stockabdeckung
Gutmann Donau 22/24 F-T1

8999-05F6

gez. : 16.06.05 Ur

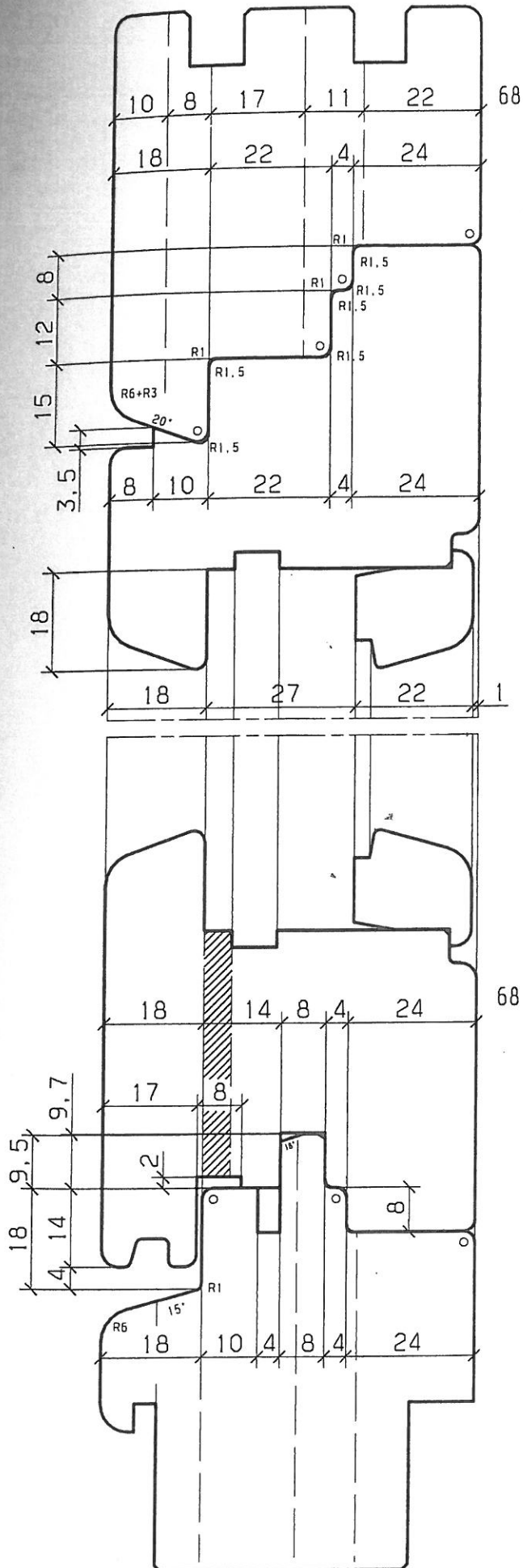

IV 22
 BISOc+Bluc
 E 8/24
 H 68/68
 BKou
 B
 TrGv

0,5 mm Luft am
 Außenanschlag

o = R2

8999-05F7

gez. : 16.06.05 Ur

Ersatzmesser		
Stk.	Kurzz.	Best-Nr.
2	HME	8999L14
2	HME R6	8999L16
2	HME R3	8999L16
Ersatzmesser 8999L15		
2	WKBA R3	6450 1001
2	HME	8117 4709
2	HMW 20	8110 5263

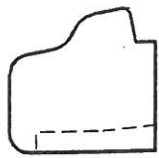

Wechselmesser vorbereitet

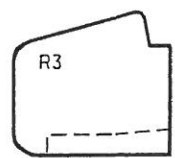

Wechselmesser vorbereitet

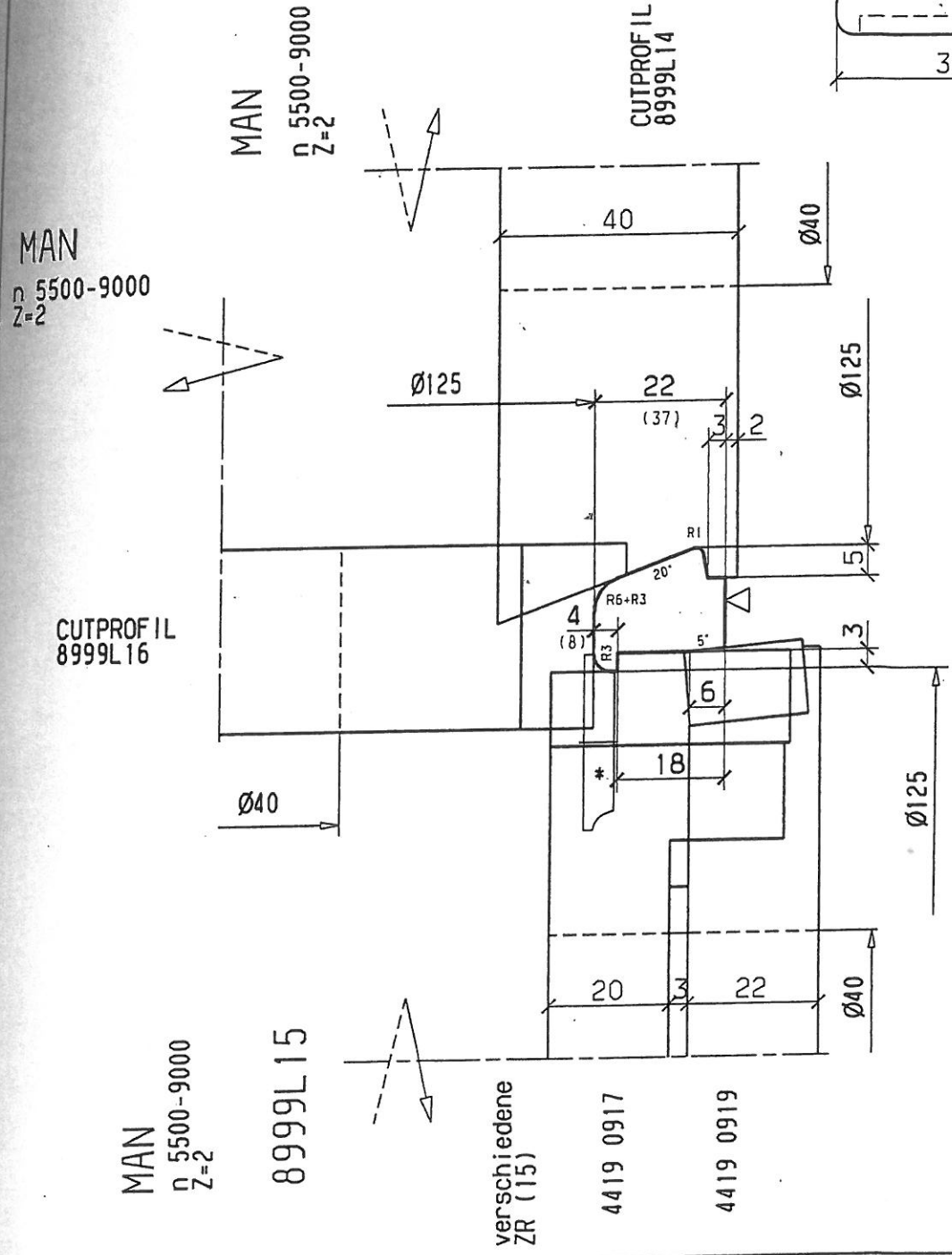
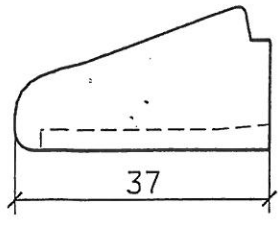

* ab Falz 5 WKBA R3 ummontieren

OPPOLD SYSTEM INTERNATIONAL
 Maschinenwerkzeuge für die Massivholzbearbeitung
 73447 Oberkochen

überfälzte Glasleiste
 CUTPROFIL
 gez. 08.07.05 Ur gepr. 28.07.05 Ur

8999-05L14+15+16
 Ersatz für:

Maßstab / CAD

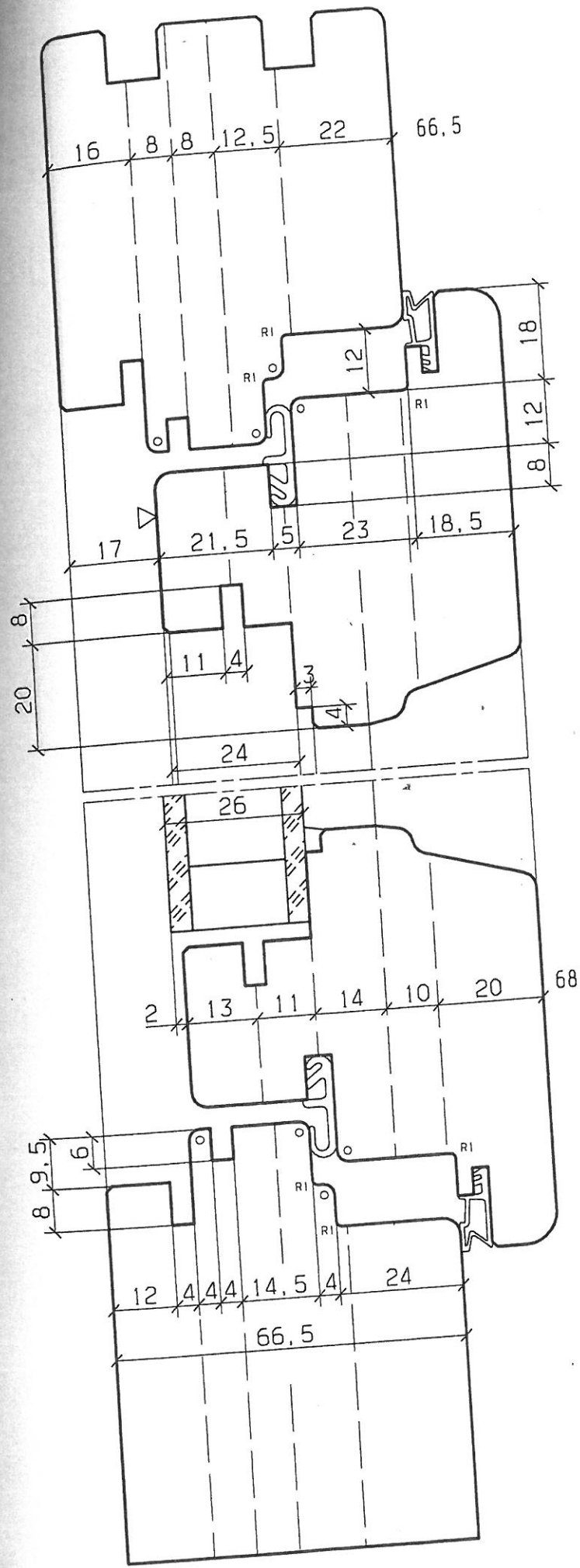

HA 22
 E 8/24
 H 68/66.5
 FD5/Dev. 103b

o = R2

passende Aluprofile:
 Uniform
 schraubenloser Halter

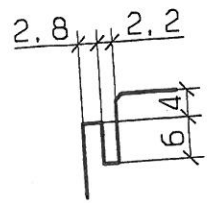

8999-05F8/1

gez. : 27.06.05 Ur

**OPPOLD
SYSTEM**

INTERNATIONAL
Tools for Woodworking
Heidenheimer Strasse 112
D-73447 Oberkochen

HA 68/68

FD
ÜD Deventer SV103b
oder ähnlich

alle nicht bemaßten
Radien R3

o = R2

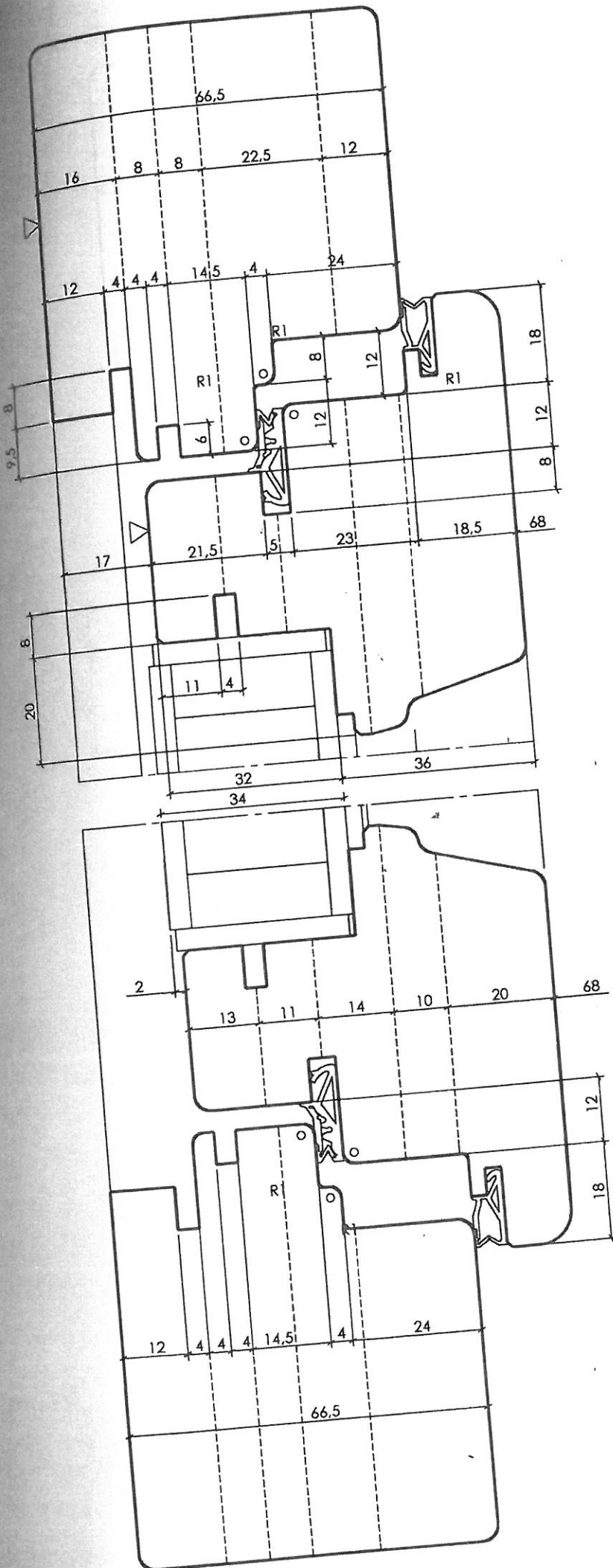
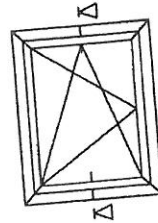

34358-14 F2-32

gez. : 18.03.2014 Ur

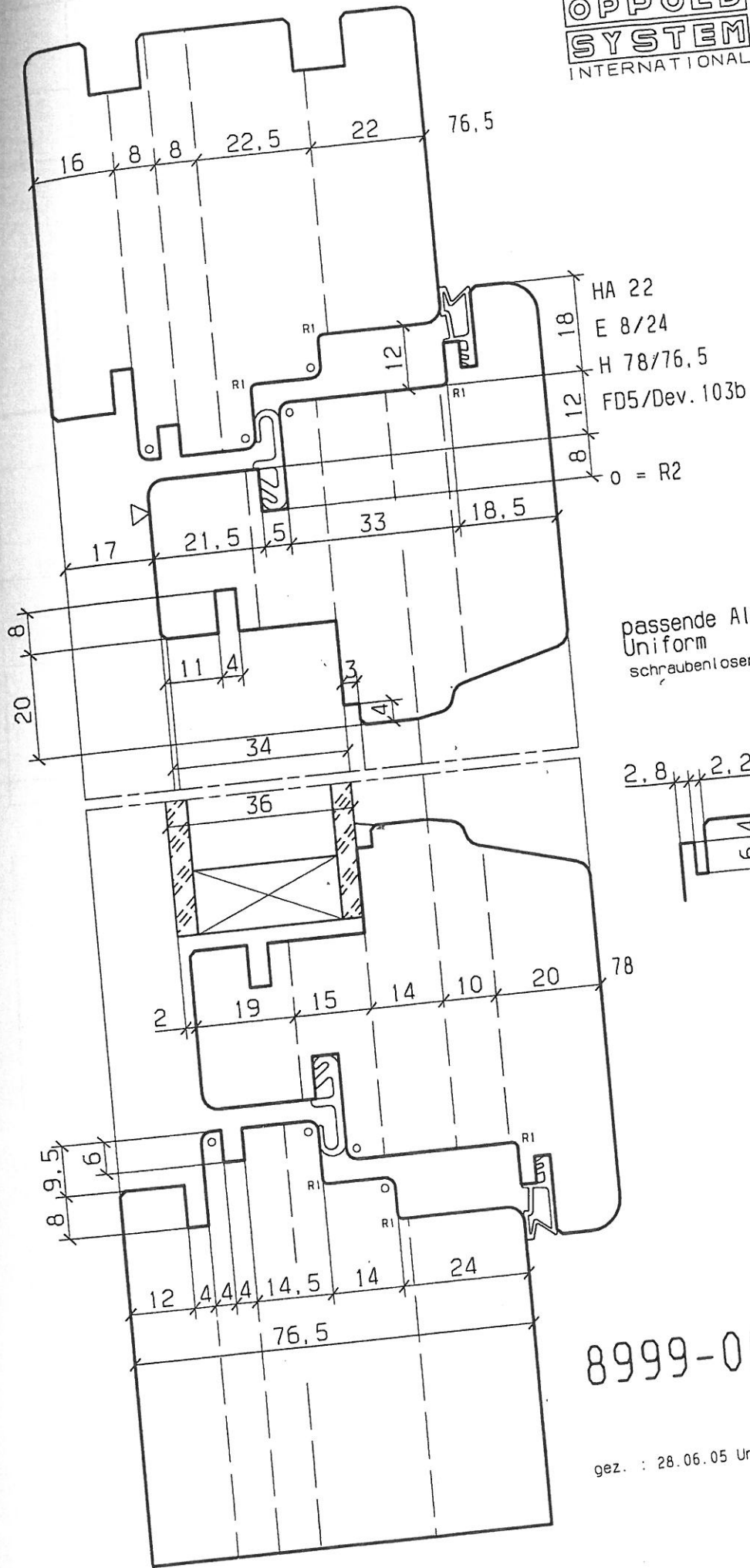

8999-05F10/2

gez. : 28.06.05 Ur

**OPPOLD
SYSTEM**

INTERNATIONAL

Tools for Woodworking
Heidenheimer Strasse 112
D-73447 Oberkochen

HA 78/76,5

FD
ÜD Deventer SV103b
oder ähnlich

alle nicht bemaßten
Radien R3

o = R2

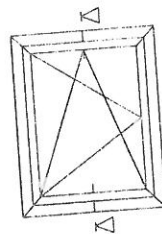

2014

DE 33?

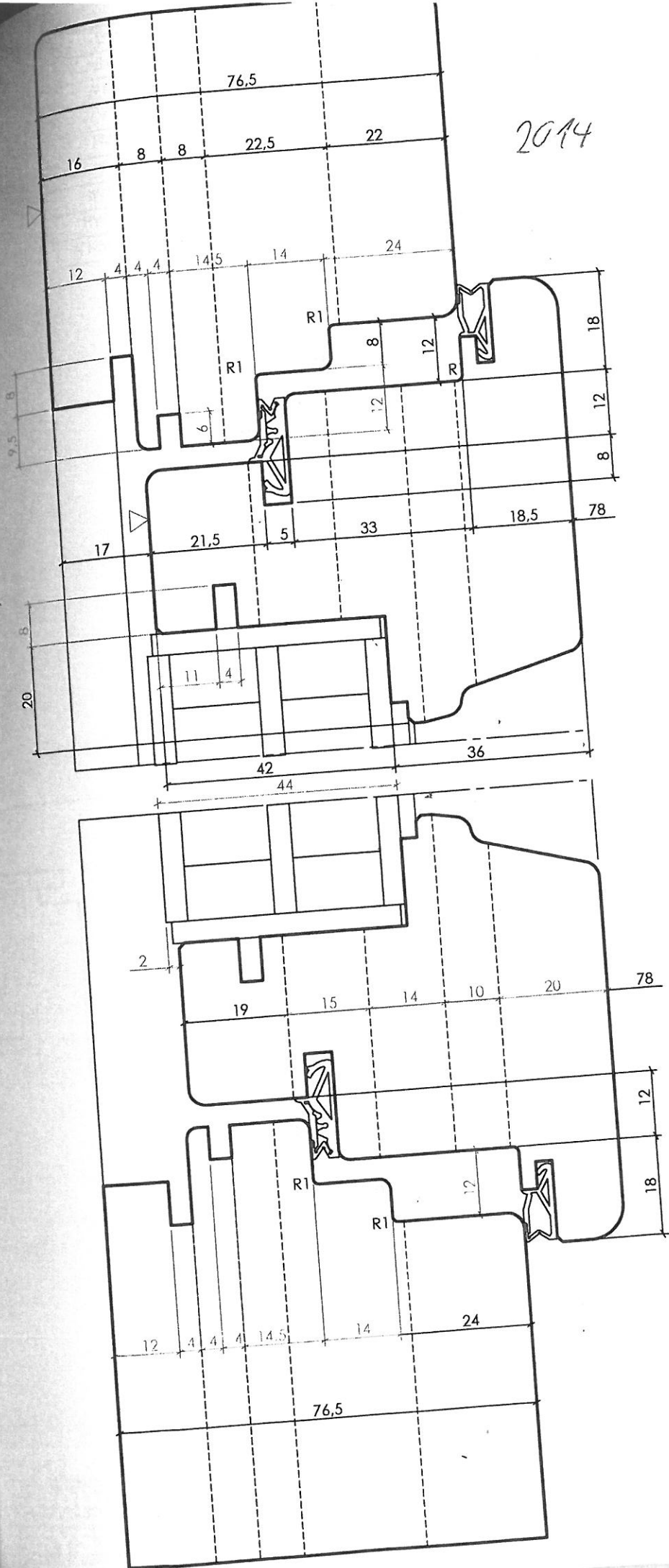

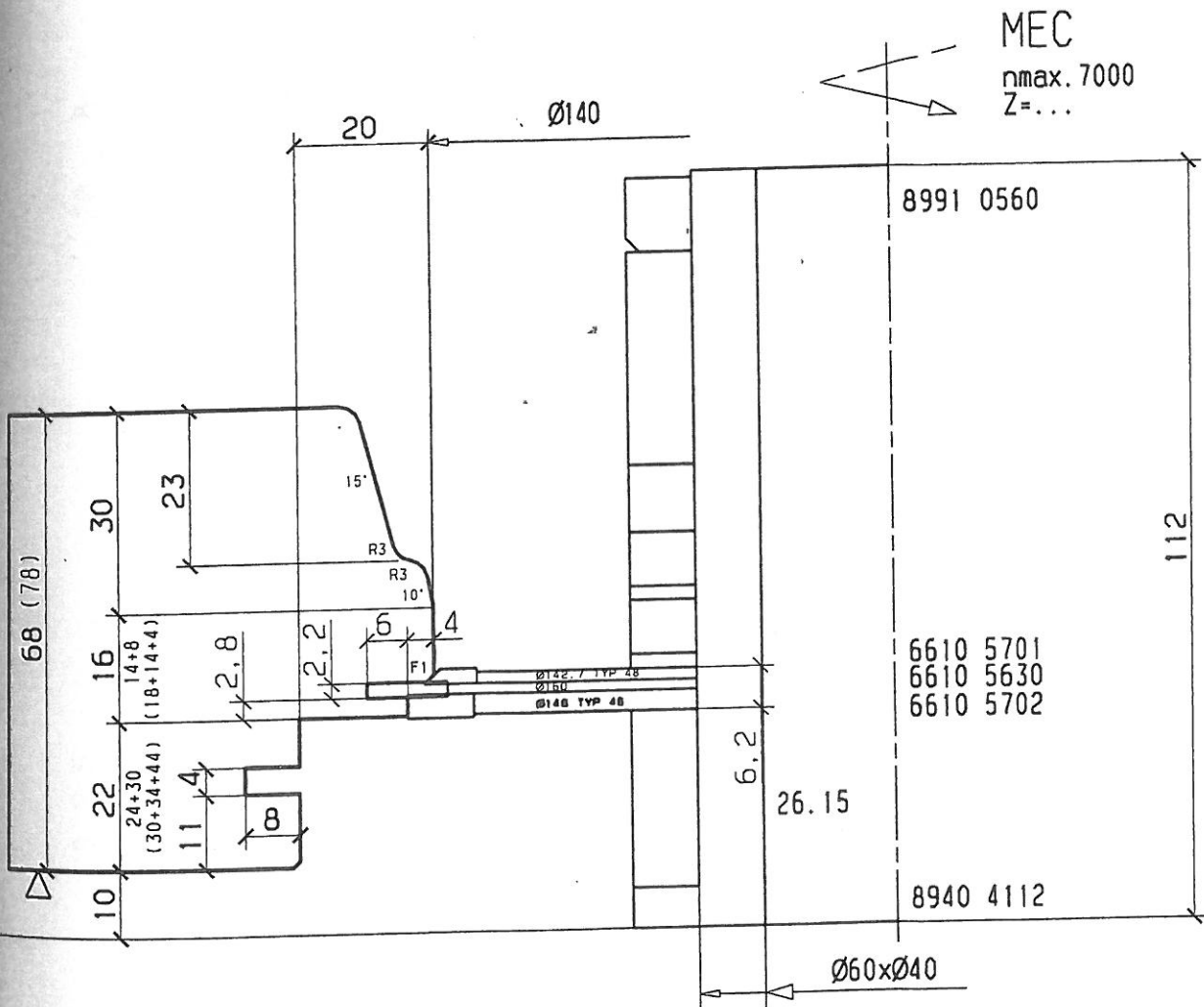

OPPOLD Maschinenwerkzeuge
für die
SYSTEM Massivholzbearbeitung
INTERNATIONAL 73447 Oberkochen

HA FI 68 Nachfräsen DE39

8999-05L23

HMW-WEFIX-LP

Maßstab / CAD

gez. 01.07.05 Ur

gepr. 28.07.05 Ur

Ersatz für:

HA 22
 FIC
 E 8/24
 H 68/66,5
 FD5/Dev. 103b

o = R2

passende Aluprofile:
 Uniform
 schraubenloser Halter

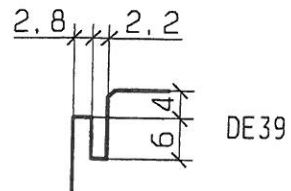
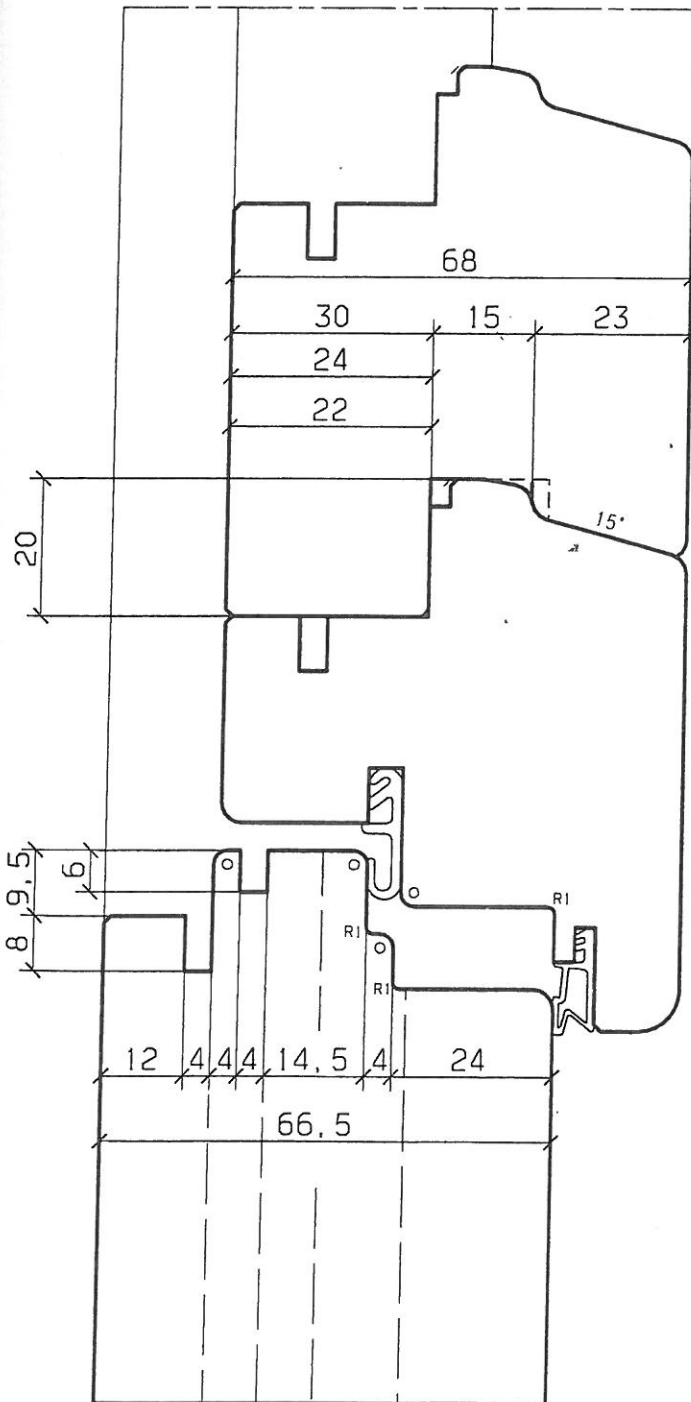

8999-05F16

Ersatzmesser	
Stk.	Best.-Nr.
2	8999L27
Kurz.	HME 14/20°R3/F

Ersatzmesser	
Stk.	Best.-Nr.
2	8999L26
Kurz.	HME 14/20°R3/F

MAN
n 5500-9000
Z=2

8999-05L27

MAN
n 5500-9000
Z=2

8999-05L26

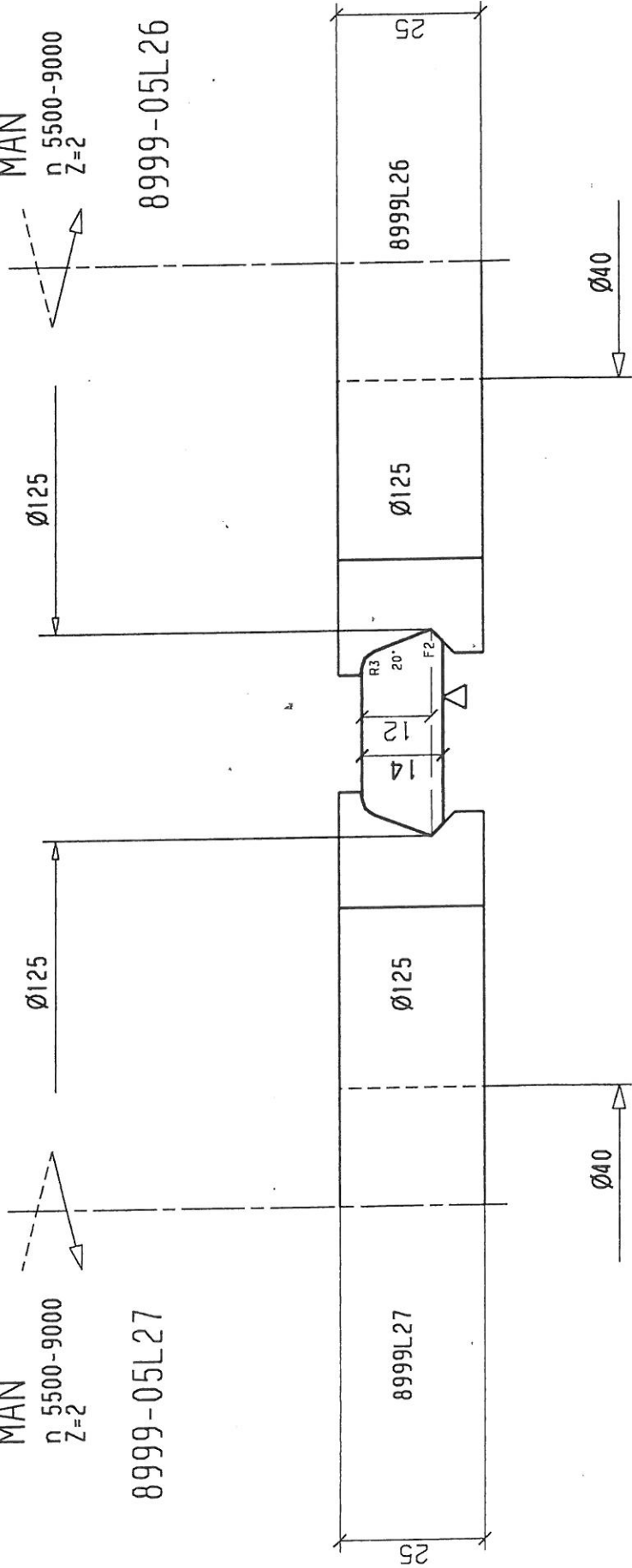

OPPOLO
SYSTEM
INTERNATIONAL 73447 Oberkochen

Glasleistenwerkzeug
Cutprofil

8999-05L26+L27

Maßstab / CAD

gez. 08.07.09 Ur

gepr. 28.07.09 Ur Ersatz für:

Ersatzmesser	
Stk.	Best.-Nr.
2	8117 4706
2	8117 4700

bei 66.5
bei 76.5
bei 86.5

12.5
22.5
28.5

10°
15°

4
20

R3
R3
R1
R2
R3

Ø125

8999-05L30

8999-05L29

MAN
n 6000-7000
Z=2

MAN
n 6000-7000
Z=2

2xZR10 lose

4419 0913

4419 0915

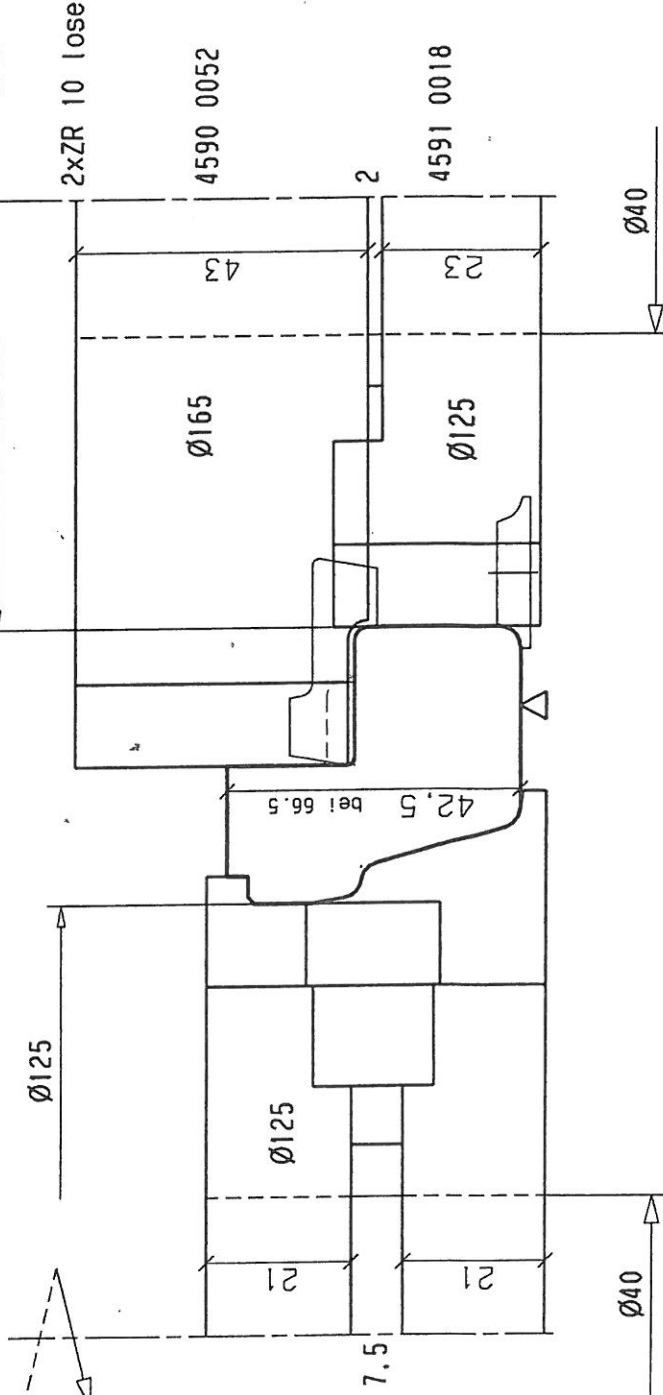

OPPOLD
SYSTEM
INTERNATIONAL

Maschinenwerkzeuge
für die
Massivholzbearbeitung
3347 Oberkochen

HA Festverglasung

für HA 66.5

HMV-WEFIX-LP

Maßstab / CAD

gez. 08.07.09 Ur

gepr. 04.10.09 Ur

Ersatz für:

8999-05L29+L30